



# Mallard Pass

Solar Farm

## Mallard Pass Solar Farm

### Traffic Regulation Measures Plans - Temporary Measures

**November 2022**

PINS Ref: EN010127

Document Ref: EN010127/APP/2.7

Revision P0

Infrastructure Planning (Applications: Prescribed Forms and Procedure) Regulations  
2009 - Reg 5 (2) (o)



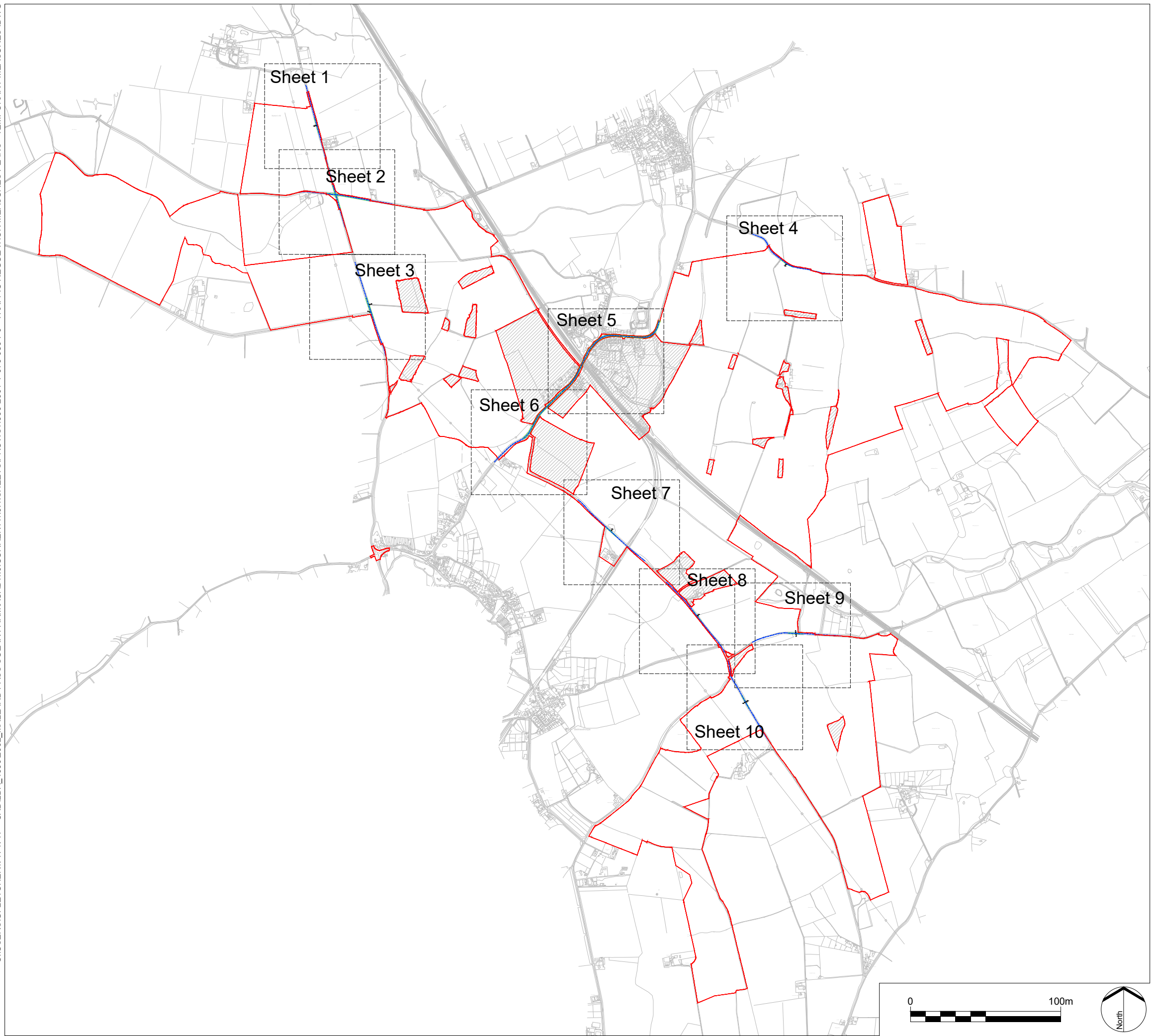

C:\USERS\FLETCHER\WORK\PROJECTS\MALLARD PASS SOLAR FARM\CAD\1.0\1. SHEETS\PROWS\4990-2001-T-079-089-P0 - TRAFFIC REGULATION MEASURES PLANS - TEMPORARY MEASURES.DWG

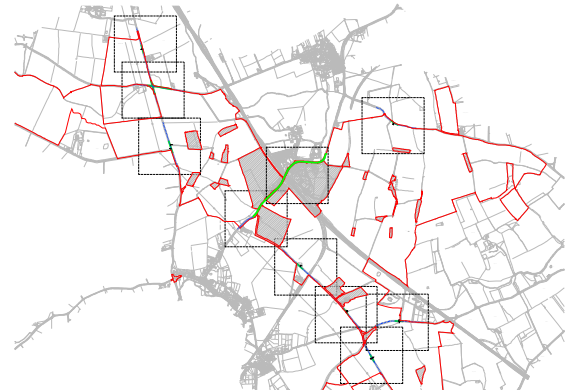

LEGEND

KEY PLAN:

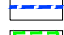

-  Order limits
-  Areas outside of Order limits
-  Proposed Temporary Speed Limit (30mph Speed Limit)
-  Proposed Temporary Traffic Signal Control Area
-  Proposed Site Access Location

- NOTES:
1. The Traffic Regulation Measures Plans should be read in conjunction with the Development Consent Order and the other plans and documents to be certified under it, in particular article 15, and Schedule 8 of the Development Consent Order.
  2. Information relating to the Public Rights of Way and accesses can be found on the rights of way and access plans.
  3. The Order limits has been drawn to the Land Registry boundaries and topographical survey data of the site. The accuracy of land registry and the topographical survey differs from the OS base mapping which results in the order limits not aligning with the line work shown on the OS mapping.

P0 Submission  
REV. DESCRIPTION

RP 18/11/22  
APP. DATE



PROJECT TITLE  
**MALLARD PASS SOLAR FARM**

DRAWING TITLE  
**TRAFFIC REGULATION MEASURES PLANS  
- TEMPORARY MEASURES - KEY PLAN**  
Infrastructure Planning (Applications:  
Prescribed Forms and Procedure) Regulations  
2009  
APFP Regulation: 5(2)(o)

PINS REFERENCE NO  
**EN010127**

ISSUED BY	Oxford	T: 01865 887 050
DATE	18 NOV 2022	DRAWN GSF
SCALE@A3	1:2,500	CHECKED CR
STATUS	Planning	APPROVED RP

**DWG. NO 4990-2001-T-079 REV : P0**

No dimensions are to be scaled from this drawing.  
All dimensions are to be checked on site.  
Area measurements for indicative purposes only.

© LDA Design Consulting Ltd. Quality Assured to BS EN ISO 9001 : 2015

Sources Ordnance Survey



C:\USERS\G\FLETCHER\VTVP - CAD\LD\_49902002\_MALLARD PASS SOLAR FARM\CAD11.0.CURRENT\1.0.1.SHEETS\PROWS\4990-2001-T-079-089-P0 - TRAFFIC REGULATION MEASURES PLANS - TEMPORARY MEASURES.DWG

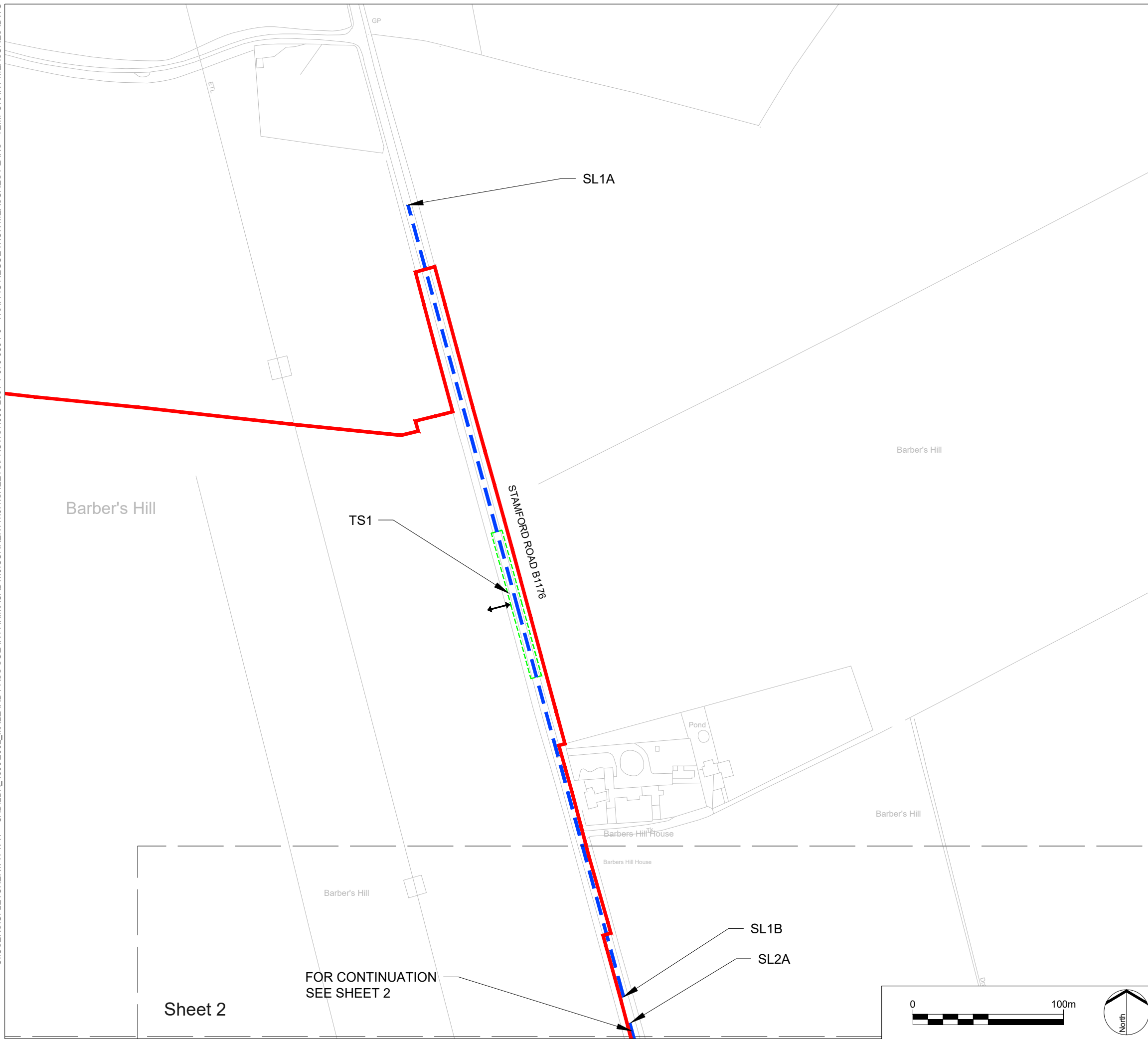

LEGEND

KEY PLAN:

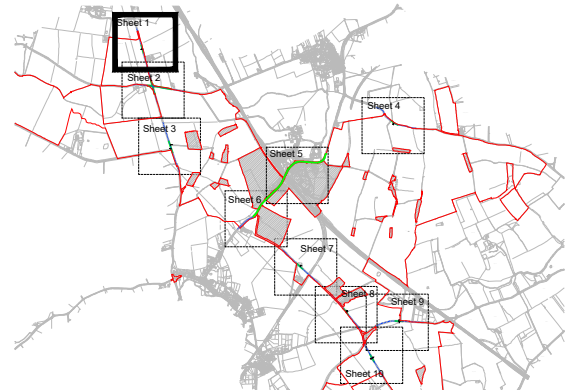

- Order limits
- Areas outside of Order limits
- Proposed Temporary Speed Limit (30mph Speed Limit)
- Proposed Temporary Traffic Signal Control Area
- Proposed Site Access Location

- NOTES:
1. The Traffic Regulation Measures Plans should be read in conjunction with the Development Consent Order and the other plans and documents to be certified under it, in particular article 15, and Schedule 8 of the Development Consent Order.
  2. Information relating to the Public Rights of Way and accesses can be found on the rights of way and access plans.
  3. The Order limits has been drawn to the Land Registry boundaries and topographical survey data of the site. The accuracy of land registry and the topographical survey differs from the OS base mapping which results in the order limits not aligning with the line work shown on the OS mapping.

REV.	DESCRIPTION	APP. DATE
P0	Submission	18/11/22



PROJECT TITLE  
**MALLARD PASS SOLAR FARM**

DRAWING TITLE  
**TRAFFIC REGULATION MEASURES PLANS - TEMPORARY MEASURES - SHEET 1 OF 10**  
 Infrastructure Planning (Applications: Prescribed Forms and Procedure) Regulations 2009  
 APFP Regulation: 5(2)(o)

PINS REFERENCE NO  
**EN010127**

ISSUED BY	Oxford	T: 01865 887 050
DATE	18 NOV 2022	DRAWN GSF
SCALE@A3	1:2,500	CHECKED CR
STATUS	Planning	APPROVED RP

**DWG. NO 4490-2001-T-080 REV : P0**

No dimensions are to be scaled from this drawing.  
 All dimensions are to be checked on site.  
 Area measurements for indicative purposes only.

© LDA Design Consulting Ltd. Quality Assured to BS EN ISO 9001 : 2015  
 Sources Ordnance Survey

C:\USERS\FLETCHER\PIVTP - CAD\LD\_49902002\_MALLARD PASS SOLAR FARM\CAD\1.0.CURRENT\1.0.1.SHEETS\PROVS\4990-2001-T-079-089-P0 - TRAFFIC REGULATION MEASURES PLANS - TEMPORARY MEASURES.DWG

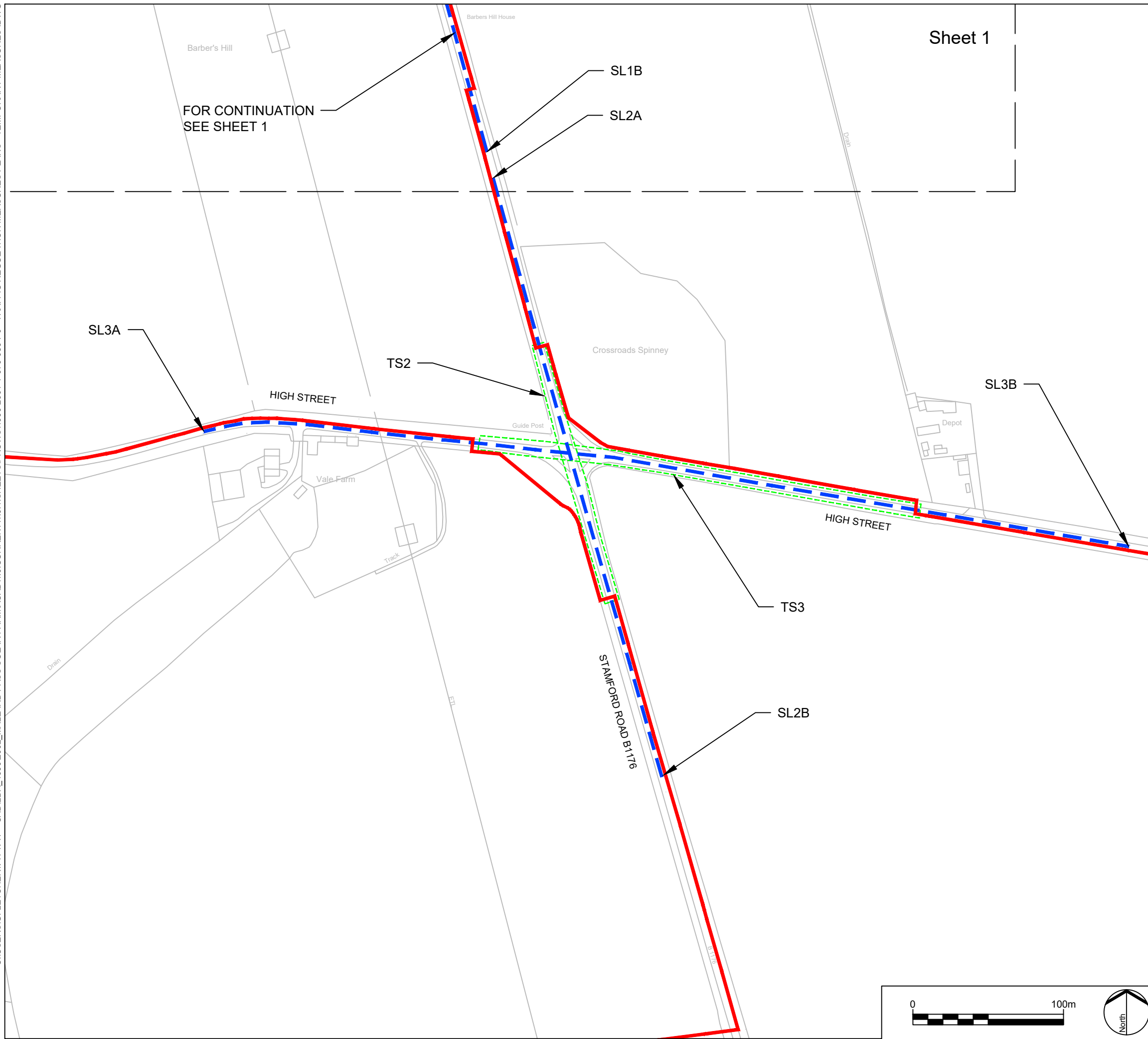

LEGEND

KEY PLAN:



- Order limits
- Areas outside of Order limits
- Proposed Temporary Speed Limit (30mph Speed Limit)
- Proposed Temporary Traffic Signal Control Area
- Proposed Site Access Location

- NOTES:
1. The Traffic Regulation Measures Plans should be read in conjunction with the Development Consent Order and the other plans and documents to be certified under it, in particular article 15, and Schedule 8 of the Development Consent Order.
  2. Information relating to the Public Rights of Way and accesses can be found on the rights of way and access plans.
  3. The Order limits has been drawn to the Land Registry boundaries and topographical survey data of the site. The accuracy of land registry and the topographical survey differs from the OS base mapping which results in the order limits not aligning with the line work shown on the OS mapping.

P0	Submission	RP	18/11/22
REV.	DESCRIPTION	APP.	DATE



PROJECT TITLE  
**MALLARD PASS SOLAR FARM**

DRAWING TITLE  
**TRAFFIC REGULATION MEASURES PLANS - TEMPORARY MEASURES - SHEET 2 OF 10**  
 Infrastructure Planning (Applications: Prescribed Forms and Procedure) Regulations 2009  
 APFP Regulation: 5(2)(o)

PINS REFERENCE NO  
**EN010127**

ISSUED BY	Oxford	T:	01865 887 050
DATE	18 NOV 2022	DRAWN	GSF
SCALE@A3	1:2,500	CHECKED	CR
STATUS	Planning	APPROVED	RP

**DWG. NO 4990-2001-T-081 REV : P0**

No dimensions are to be scaled from this drawing. All dimensions are to be checked on site. Area measurements for indicative purposes only.

© LDA Design Consulting Ltd. Quality Assured to BS EN ISO 9001 : 2015  
Sources Ordnance Survey



C:\USERS\FLETCHER\PIVTP - CAD\LD\_49902002\_MALLARD PASS SOLAR FARM\CAD1.0.CURRENT\1.0.1.SHEETS\PROWS\4990-2001-T-079-089-P0 - TRAFFIC REGULATION MEASURES PLANS - TEMPORARY MEASURES.DWG

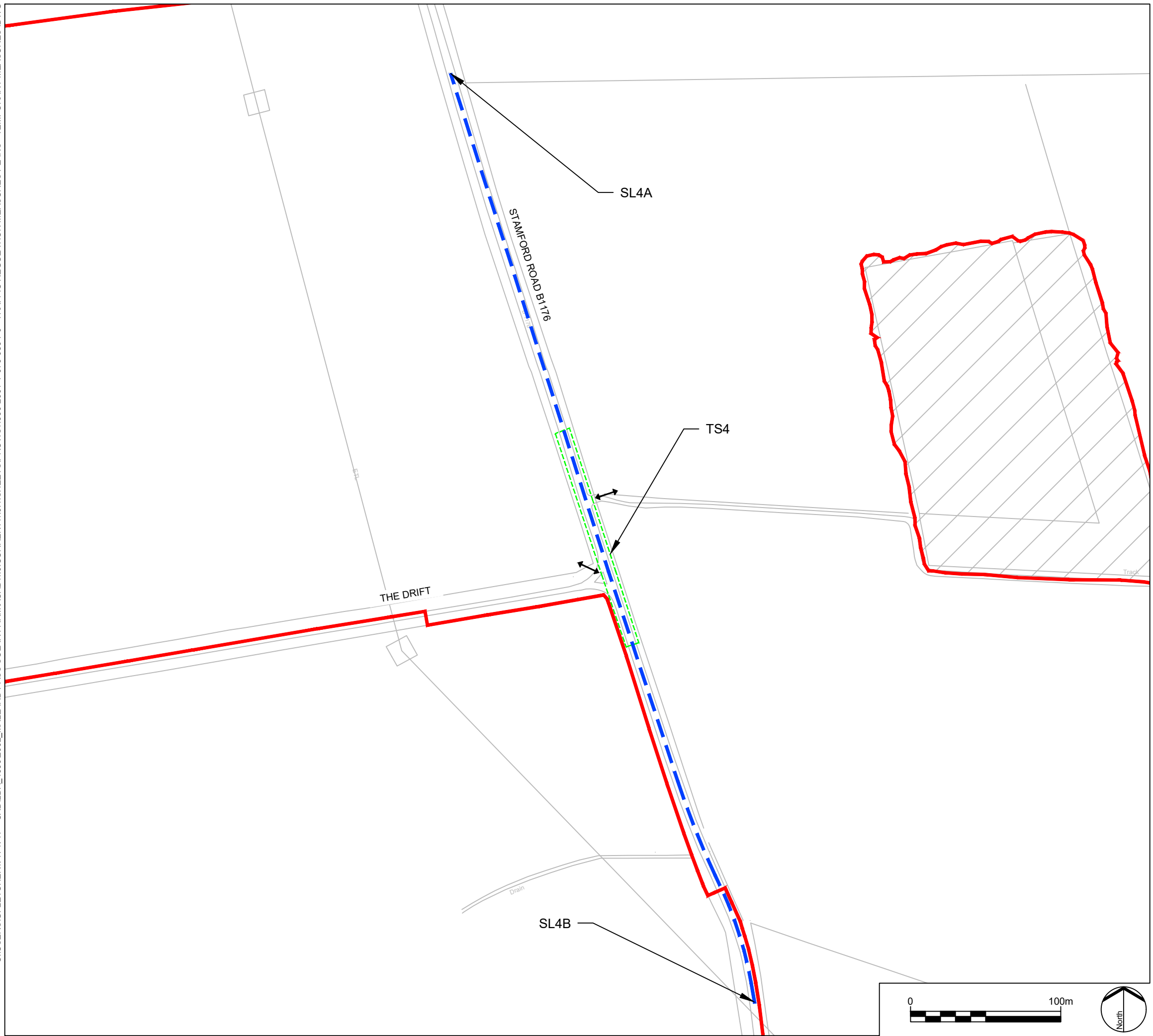

LEGEND

KEY PLAN:



- Order limits
- Areas outside of Order limits
- Proposed Temporary Speed Limit (30mph Speed Limit)
- Proposed Temporary Traffic Signal Control Area
- Proposed Site Access Location

- NOTES:
1. The Traffic Regulation Measures Plans should be read in conjunction with the Development Consent Order and the other plans and documents to be certified under it, in particular article 15, and Schedule 8 of the Development Consent Order.
  2. Information relating to the Public Rights of Way and accesses can be found on the rights of way and access plans.
  3. The Order limits has been drawn to the Land Registry boundaries and topographical survey data of the site. The accuracy of land registry and the topographical survey differs from the OS base mapping which results in the order limits not aligning with the line work shown on the OS mapping.

REV.	DESCRIPTION	APP. DATE
P0	Submission	18/11/22



PROJECT TITLE  
**MALLARD PASS SOLAR FARM**

DRAWING TITLE  
**TRAFFIC REGULATION MEASURES PLANS - TEMPORARY MEASURES - SHEET 3 OF 10**  
 Infrastructure Planning (Applications: Prescribed Forms and Procedure) Regulations 2009  
 APFP Regulation: 5(2)(o)

PINS REFERENCE NO  
**EN010127**

ISSUED BY	Oxford	T: 01865 887 050
DATE	18 NOV 2022	DRAWN GSF
SCALE@A3	1:2,500	CHECKED CR
STATUS	Planning	APPROVED RP

**DWG. NO 4990-2001-T-082 REV : P0**

No dimensions are to be scaled from this drawing.  
 All dimensions are to be checked on site.  
 Area measurements for indicative purposes only.

© LDA Design Consulting Ltd. Quality Assured to BS EN ISO 9001 : 2015  
 Sources Ordnance Survey



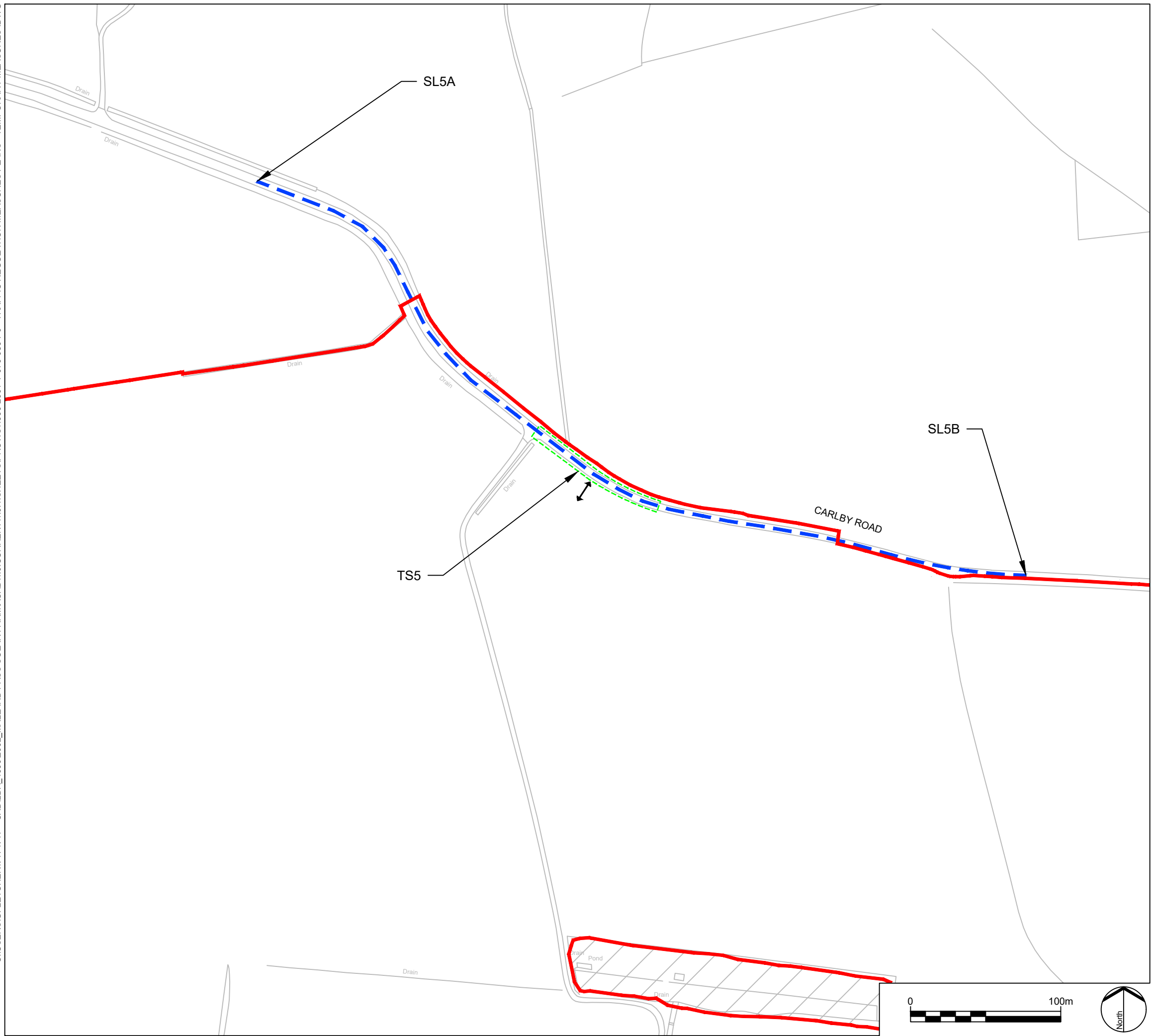

C:\USERS\FLETCHER\WORK\PROJECTS\4990-2001-T-089-P0 - TRAFFIC REGULATION MEASURES PLANS - TEMPORARY MEASURES.DWG



LEGEND

KEY PLAN:

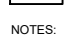

-  Order limits
-  Areas outside of Order limits
-  Proposed Temporary Speed Limit (30mph Speed Limit)
-  Proposed Temporary Traffic Signal Control Area
-  Proposed Site Access Location

- NOTES:
1. The Traffic Regulation Measures Plans should be read in conjunction with the Development Consent Order and the other plans and documents to be certified under it, in particular article 15, and Schedule 8 of the Development Consent Order.
  2. Information relating to the Public Rights of Way and accesses can be found on the rights of way and access plans.
  3. The Order limits has been drawn to the Land Registry boundaries and topographical survey data of the site. The accuracy of land registry and the topographical survey differs from the OS base mapping which results in the order limits not aligning with the line work shown on the OS mapping.

P0	Submission	RP	18/11/22
REV.	DESCRIPTION	APP.	DATE



PROJECT TITLE  
**MALLARD PASS SOLAR FARM**

DRAWING TITLE  
**TRAFFIC REGULATION MEASURES PLANS  
 - TEMPORARY MEASURES - SHEET 4 OF 10**  
 Infrastructure Planning (Applications:  
 Prescribed Forms and Procedure) Regulations  
 2009  
 APFP Regulation: 5(2)(o)

PINS REFERENCE NO  
**EN010127**

ISSUED BY	Oxford	T: 01865 887 050
DATE	18 NOV 2022	DRAWN GSF
SCALE@A3	1:2,500	CHECKED CR
STATUS	Planning	APPROVED RP

**DWG. NO 4990-2001-T-083 REV : P0**

No dimensions are to be scaled from this drawing.  
All dimensions are to be checked on site.  
Area measurements for indicative purposes only.

© LDA Design Consulting Ltd. Quality Assured to BS EN ISO 9001 : 2015  
Sources Ordnance Survey

C:\USERS\G\FLETCHER\VTVP - CAD\DA\_49902002\_MALLARD PASS SOLAR FARM\CAD11.0.CURRENT\11.0.1.SHEETS\PROVS\4990-2001-T-079-089-P0 - TRAFFIC REGULATION MEASURES PLANS - TEMPORARY MEASURES.DWG

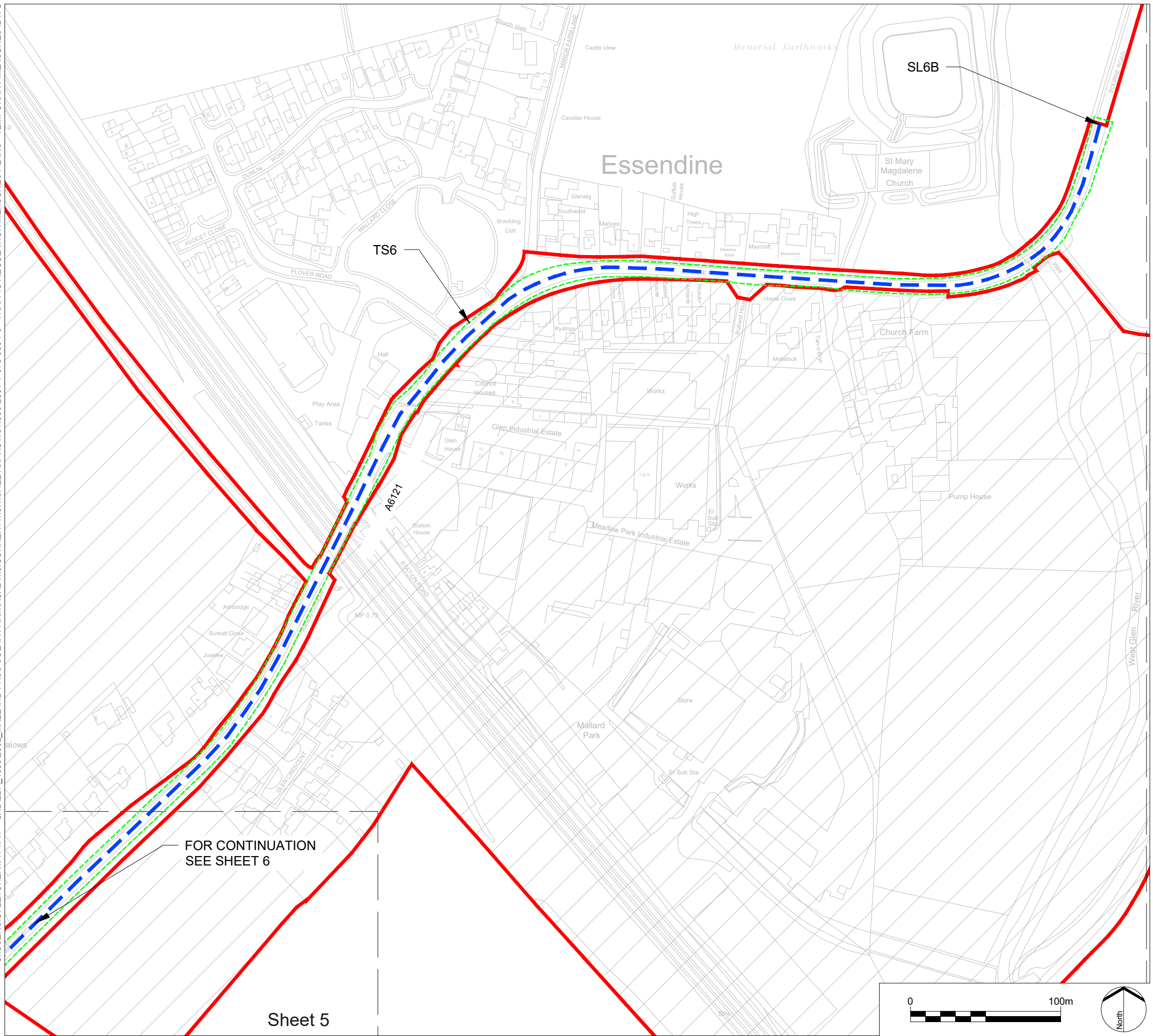

LEGEND

KEY PLAN:

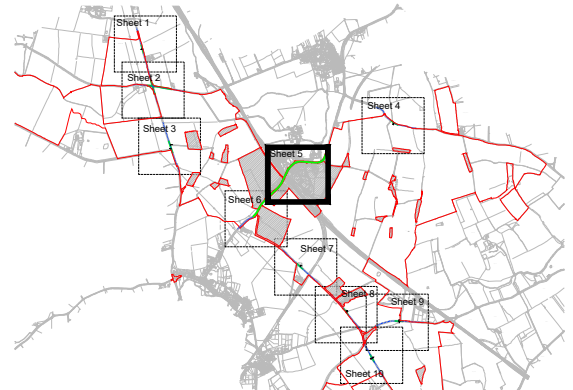

- Order limits
- Areas outside of Order limits
- Proposed Temporary Speed Limit (30mph Speed Limit)
- Proposed Temporary Traffic Signal Control Area
- Proposed Site Access Location

- NOTES:
1. The Traffic Regulation Measures Plans should be read in conjunction with the Development Consent Order and the other plans and documents to be certified under it, in particular article 15, and Schedule 8 of the Development Consent Order.
  2. Information relating to the Public Rights of Way and accesses can be found on the rights of way and access plans.
  3. The Order limits has been drawn to the Land Registry boundaries and topographical survey data of the site. The accuracy of land registry and the topographical survey differs from the OS base mapping which results in the order limits not aligning with the line work shown on the OS mapping.

P0 Submission  
REV. DESCRIPTION

RP 18/11/22  
APP. DATE



PROJECT TITLE  
**MALLARD PASS SOLAR FARM**

DRAWING TITLE  
**TRAFFIC REGULATION MEASURES PLANS  
- TEMPORARY MEASURES - SHEET 5 OF 10**  
Infrastructure Planning (Applications:  
Prescribed Forms and Procedure) Regulations  
2009  
APFP Regulation: 5(2)(o)

PINS REFERENCE NO  
**EN010127**

ISSUED BY	Oxford	T: 01865 887 050
DATE	18 NOV 2022	DRAWN GSF
SCALE@A3	1:2,500	CHECKED CR
STATUS	Planning	APPROVED RP

**DWG. NO 4990-2001-T-084 REV : P0**

No dimensions are to be scaled from this drawing.  
All dimensions are to be checked on site.  
Area measurements for indicative purposes only.

© LDA Design Consulting Ltd. Quality Assured to BS EN ISO 9001 : 2015

Sources Ordnance Survey

Sheet 5





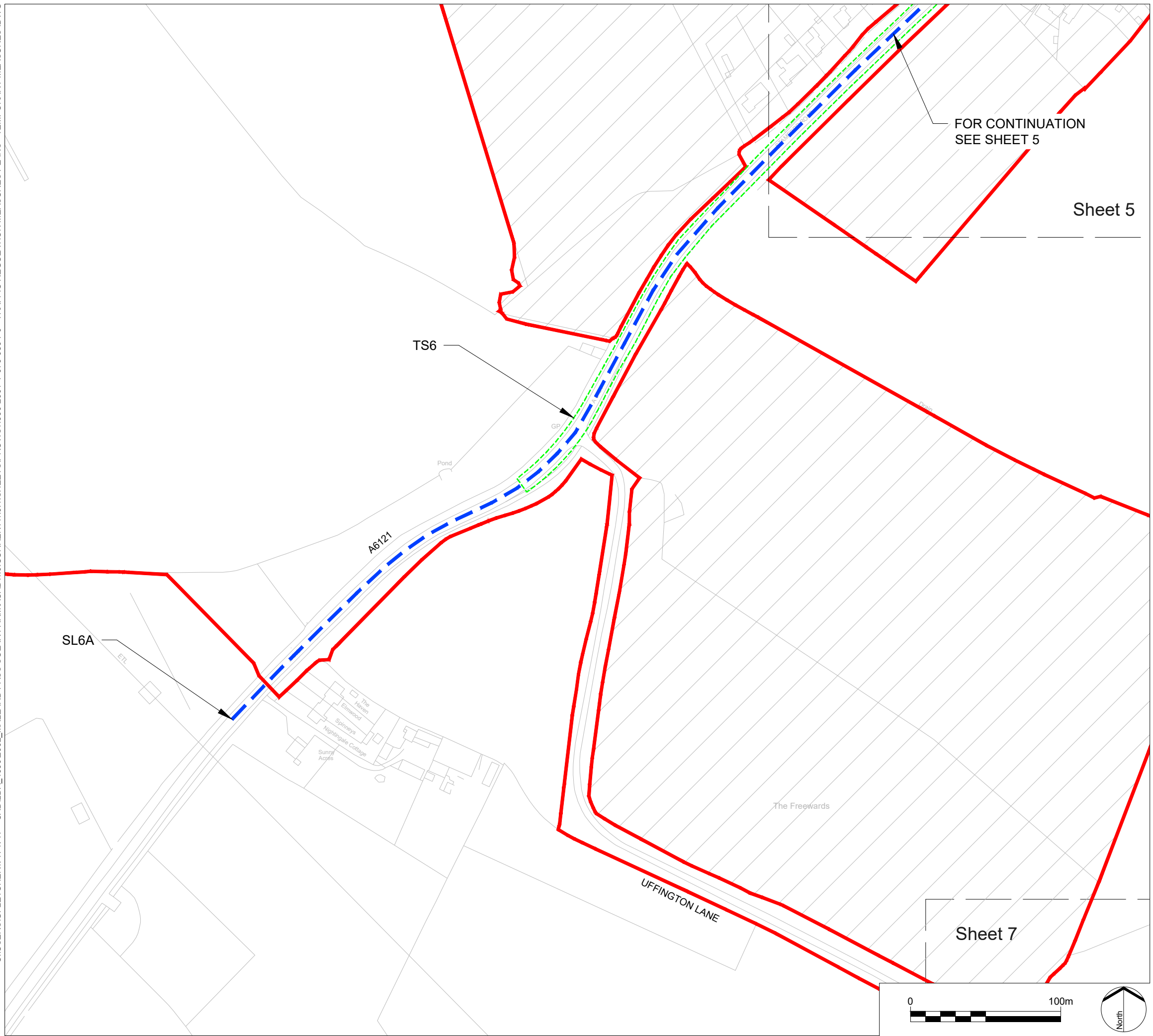

C:\USERS\G\FLETCHER\PIVTP - CAD\DA\_49902002\_MALLARD PASS SOLAR FARM\CAD\1.0.CURRENT\1.0.1.SHEETS\PROWS\4990-2001-T-079-089-P0 - TRAFFIC REGULATION MEASURES PLANS - TEMPORARY MEASURES.DWG

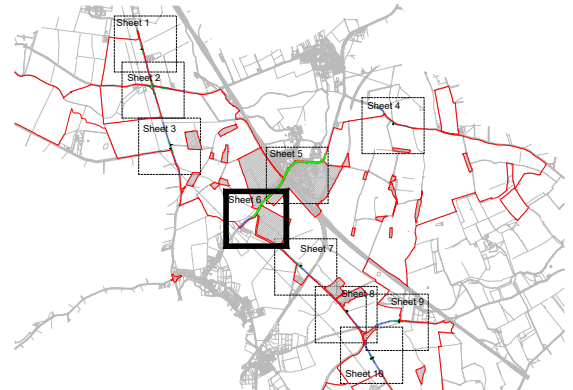

LEGEND

KEY PLAN:

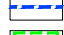

-  Order limits
-  Areas outside of Order limits
-  Proposed Temporary Speed Limit (30mph Speed Limit)
-  Proposed Temporary Traffic Signal Control Area
-  Proposed Site Access Location

- NOTES:
1. The Traffic Regulation Measures Plans should be read in conjunction with the Development Consent Order and the other plans and documents to be certified under it, in particular article 15, and Schedule 8 of the Development Consent Order.
  2. Information relating to the Public Rights of Way and accesses can be found on the rights of way and access plans.
  3. The Order limits has been drawn to the Land Registry boundaries and topographical survey data of the site. The accuracy of land registry and the topographical survey differs from the OS base mapping which results in the order limits not aligning with the line work shown on the OS mapping.

P0 Submission  
 REV. DESCRIPTION

RP 18/11/22  
 APP. DATE



PROJECT TITLE  
**MALLARD PASS SOLAR FARM**

DRAWING TITLE  
**TRAFFIC REGULATION MEASURES PLANS  
 - TEMPORARY MEASURES - SHEET 6 OF 10**  
 Infrastructure Planning (Applications:  
 Prescribed Forms and Procedure) Regulations  
 2009  
 APFP Regulation: 5(2)(o)

PINS REFERENCE NO  
**EN010127**

ISSUED BY	Oxford	T: 01865 887 050
DATE	18 NOV 2022	DRAWN GSF
SCALE@A3	1:2,500	CHECKED CR
STATUS	Planning	APPROVED RP

**DWG. NO 4990-2001-T-085 REV : P0**

No dimensions are to be scaled from this drawing.  
 All dimensions are to be checked on site.  
 Area measurements for indicative purposes only.

© LDA Design Consulting Ltd. Quality Assured to BS EN ISO 9001 : 2015

Sources Ordnance Survey



C:\USERS\FLETCHER\VTVP - CAD\LD\_49902002\_MALLARD PASS SOLAR FARM\CAD\1.0.CURRENT\1.0.1.SHEETS\PROWS\4990-2001-T-079-089-P0 - TRAFFIC REGULATION MEASURES PLANS - TEMPORARY MEASURES.DWG

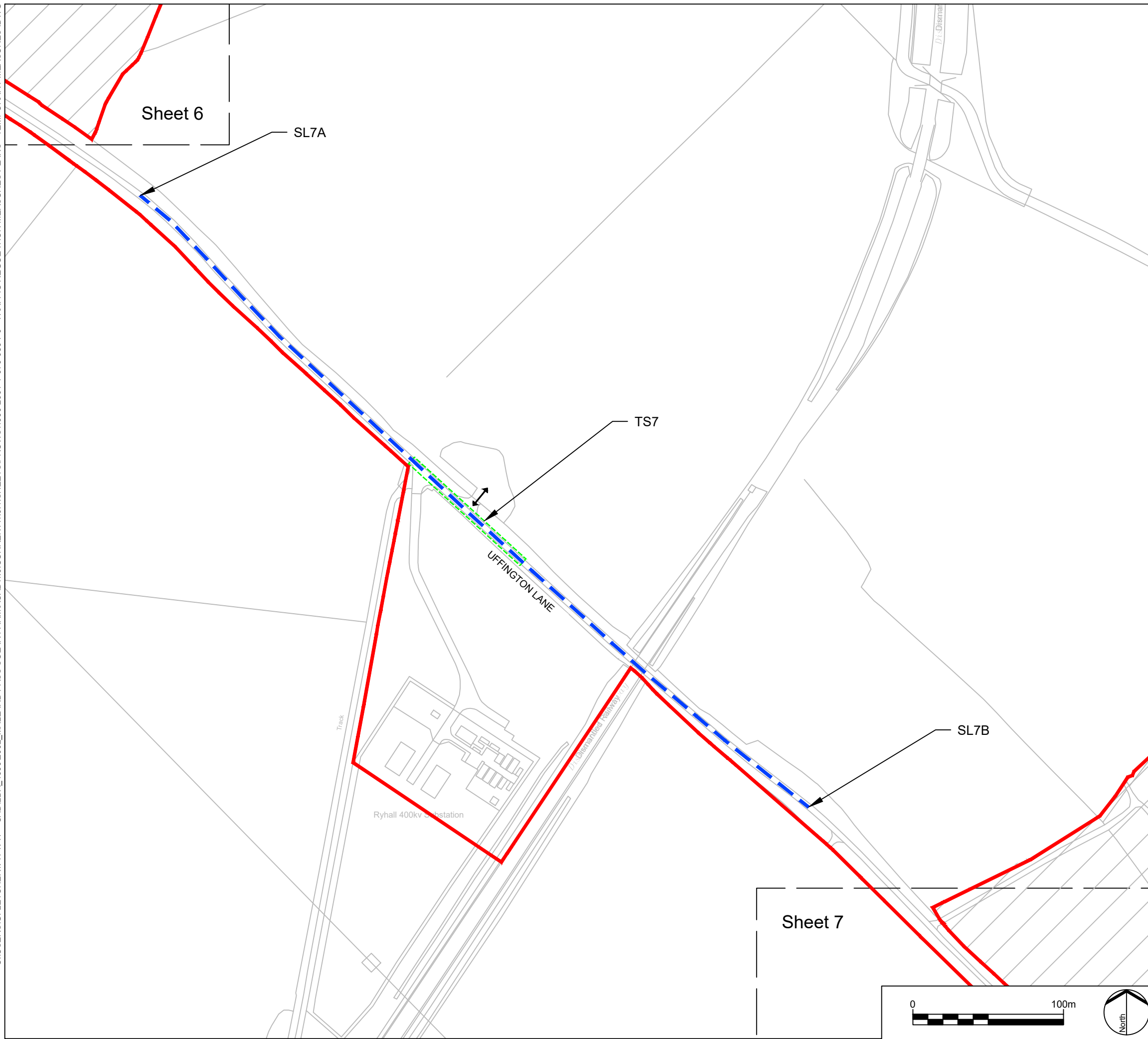

LEGEND

KEY PLAN:



- Order limits
- Areas outside of Order limits
- Proposed Temporary Speed Limit (30mph Speed Limit)
- Proposed Temporary Traffic Signal Control Area
- Proposed Site Access Location

- NOTES:
1. The Traffic Regulation Measures Plans should be read in conjunction with the Development Consent Order and the other plans and documents to be certified under it, in particular article 15, and Schedule 8 of the Development Consent Order.
  2. Information relating to the Public Rights of Way and accesses can be found on the rights of way and access plans.
  3. The Order limits has been drawn to the Land Registry boundaries and topographical survey data of the site. The accuracy of land registry and the topographical survey differs from the OS base mapping which results in the order limits not aligning with the line work shown on the OS mapping.

P0	Submission	RP	18/11/22
REV.	DESCRIPTION	APP.	DATE



PROJECT TITLE  
**MALLARD PASS SOLAR FARM**

DRAWING TITLE  
**TRAFFIC REGULATION MEASURES PLANS - TEMPORARY MEASURES - SHEET 7 OF 10**  
 Infrastructure Planning (Applications: Prescribed Forms and Procedure) Regulations 2009  
 APFP Regulation: 5(2)(o)

PINS REFERENCE NO  
**EN010127**

ISSUED BY	Oxford	T: 01865 887 050
DATE	18 NOV 2022	DRAWN GSF
SCALE@A3	1:2,500	CHECKED CR
STATUS	Planning	APPROVED RP

**DWG. NO 4990-2001-T-086**      **REV : P0**

No dimensions are to be scaled from this drawing.  
 All dimensions are to be checked on site.  
 Area measurements for indicative purposes only.

© LDA Design Consulting Ltd. Quality Assured to BS EN ISO 9001 : 2015  
 Sources Ordnance Survey

C:\USERS\FLETCHER\WORK\PROJECTS\4990-2001-T-079-089-P0 - TRAFFIC REGULATION MEASURES PLANS - TEMPORARY MEASURES.DWG

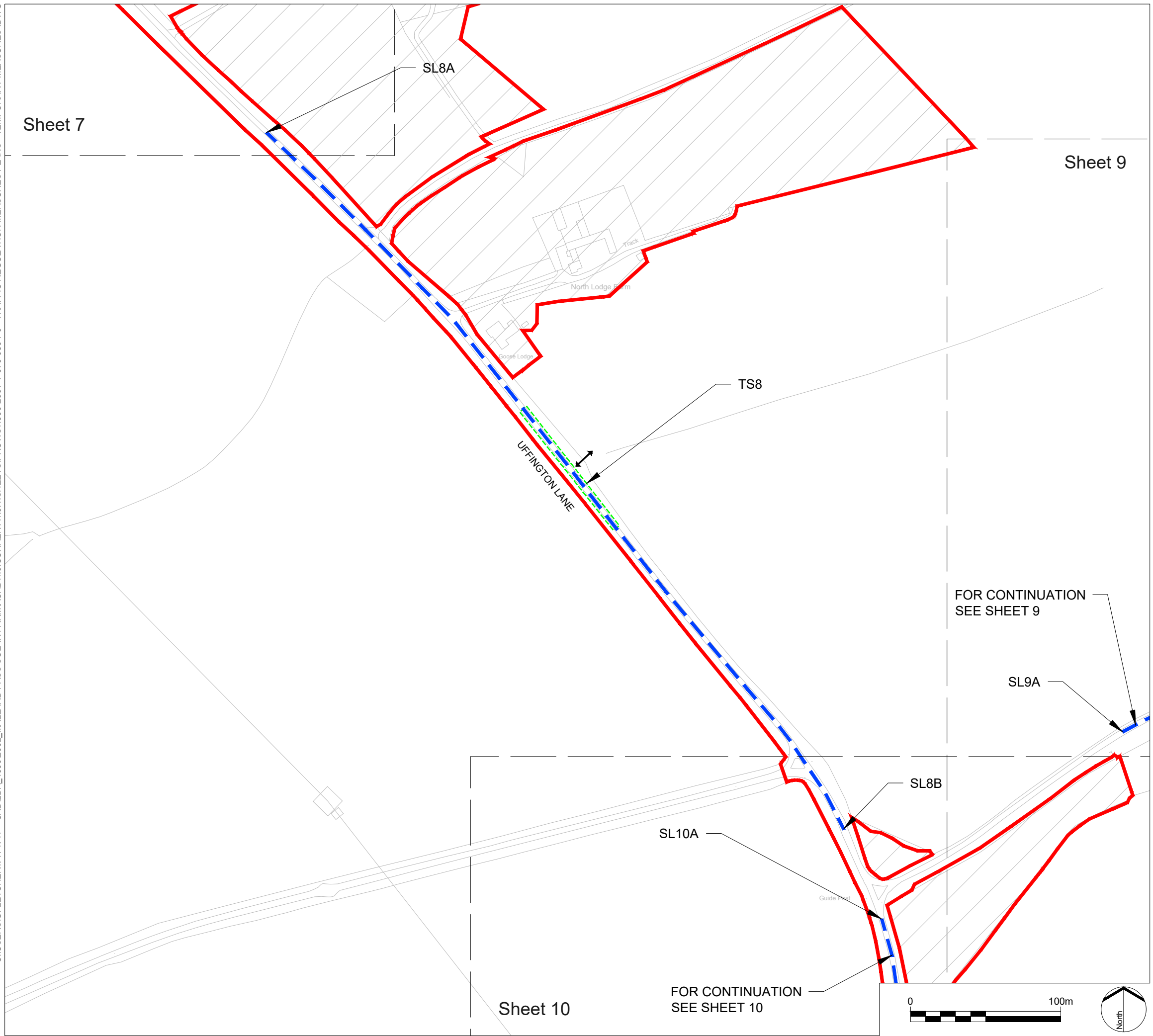

LEGEND

KEY PLAN:

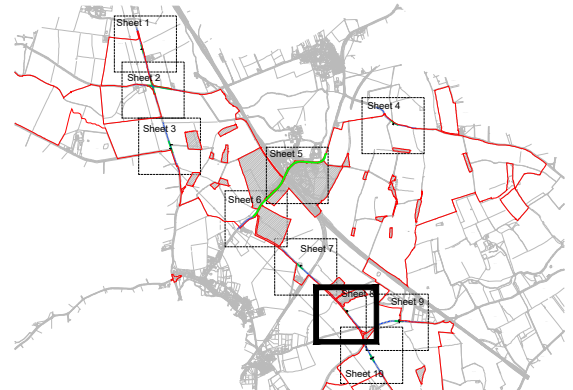

- Order limits
- Areas outside of Order limits
- Proposed Temporary Speed Limit (30mph Speed Limit)
- Proposed Temporary Traffic Signal Control Area
- Proposed Site Access Location

- NOTES:
1. The Traffic Regulation Measures Plans should be read in conjunction with the Development Consent Order and the other plans and documents to be certified under it, in particular article 15, and Schedule 8 of the Development Consent Order.
  2. Information relating to the Public Rights of Way and accesses can be found on the rights of way and access plans.
  3. The Order limits has been drawn to the Land Registry boundaries and topographical survey data of the site. The accuracy of land registry and the topographical survey differs from the OS base mapping which results in the order limits not aligning with the line work shown on the OS mapping.

P0	Submission
REV.	DESCRIPTION

MK	18/11/22
APP.	DATE



PROJECT TITLE  
**MALLARD PASS SOLAR FARM**

DRAWING TITLE  
**TRAFFIC REGULATION MEASURES PLANS - TEMPORARY MEASURES - SHEET 8 OF 10**  
 Infrastructure Planning (Applications: Prescribed Forms and Procedure) Regulations 2009  
 APFP Regulation: 5(2)(o)

PINS REFERENCE NO  
**EN010127**

ISSUED BY	Oxford	T: 01865 887 050
DATE	18 NOV 2022	DRAWN GSF
SCALE@A3	1:2,500	CHECKED CR
STATUS	Planning	APPROVED RP

**DWG. NO 4990-2001-T-087 REV : P0**

No dimensions are to be scaled from this drawing.  
 All dimensions are to be checked on site.  
 Area measurements for indicative purposes only.

© LDA Design Consulting Ltd. Quality Assured to BS EN ISO 9001 : 2015

Sources Ordnance Survey



C:\USERS\FLETCHER\WORK\PROJECTS\4990-2001-T-079-089-P0 - TRAFFIC REGULATION MEASURES PLANS - TEMPORARY MEASURES.DWG

Sheet 8

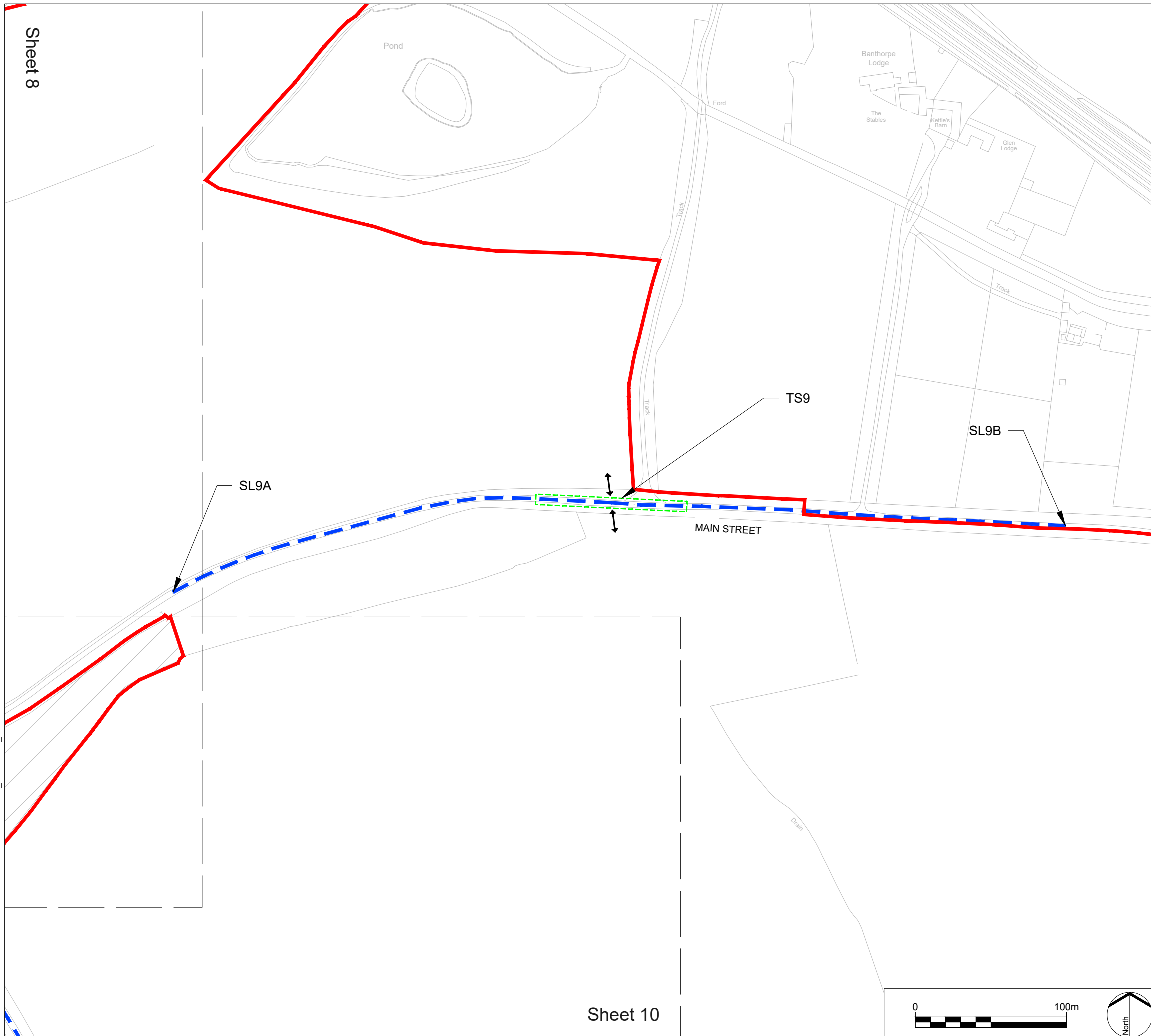

Sheet 10

LEGEND

KEY PLAN:

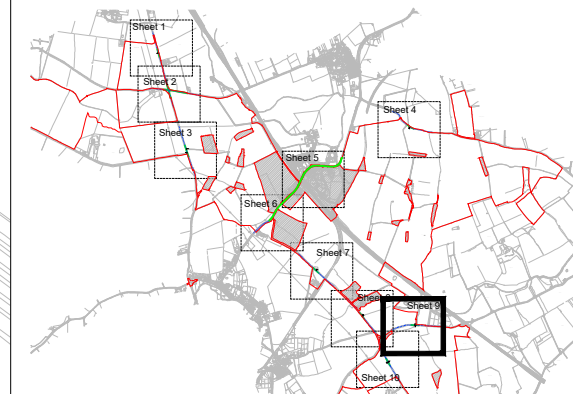

- Order limits
- Areas outside of Order limits
- Proposed Temporary Speed Limit (30mph Speed Limit)
- Proposed Temporary Traffic Signal Control Area
- Proposed Site Access Location

- NOTES:
1. The Traffic Regulation Measures Plans should be read in conjunction with the Development Consent Order and the other plans and documents to be certified under it, in particular article 15, and Schedule 8 of the Development Consent Order.
  2. Information relating to the Public Rights of Way and accesses can be found on the rights of way and access plans.
  3. The Order limits has been drawn to the Land Registry boundaries and topographical survey data of the site. The accuracy of land registry and the topographical survey differs from the OS base mapping which results in the order limits not aligning with the line work shown on the OS mapping.

P0 Submission  
 REV. DESCRIPTION

RP 18/11/22  
 APP. DATE



PROJECT TITLE  
**MALLARD PASS SOLAR FARM**

DRAWING TITLE  
**TRAFFIC REGULATION MEASURES PLANS - TEMPORARY MEASURES - SHEET 9 OF 10**  
 Infrastructure Planning (Applications: Prescribed Forms and Procedure) Regulations 2009  
 APFP Regulation: 5(2)(o)

PINS REFERENCE NO  
**EN010127**

ISSUED BY	Oxford	T: 01865 887 050
DATE	18 NOV 2022	DRAWN GSF
SCALE@A3	1:2,500	CHECKED CR
STATUS	Planning	APPROVED RP

**DWG. NO 4990-2001-T-088 REV : P0**

No dimensions are to be scaled from this drawing.  
 All dimensions are to be checked on site.  
 Area measurements for indicative purposes only.

© LDA Design Consulting Ltd. Quality Assured to BS EN ISO 9001 : 2015  
 Sources Ordnance Survey



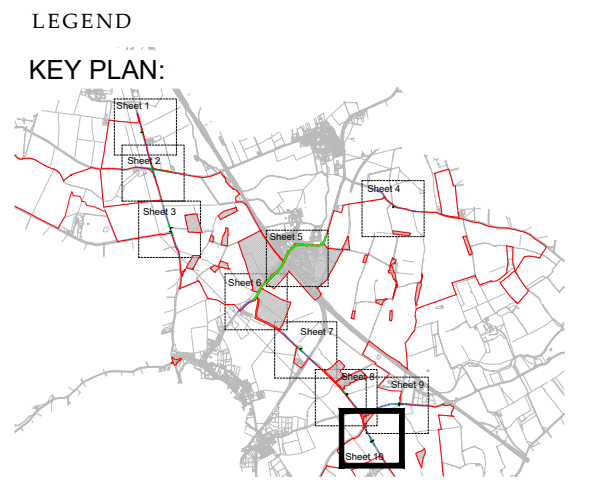
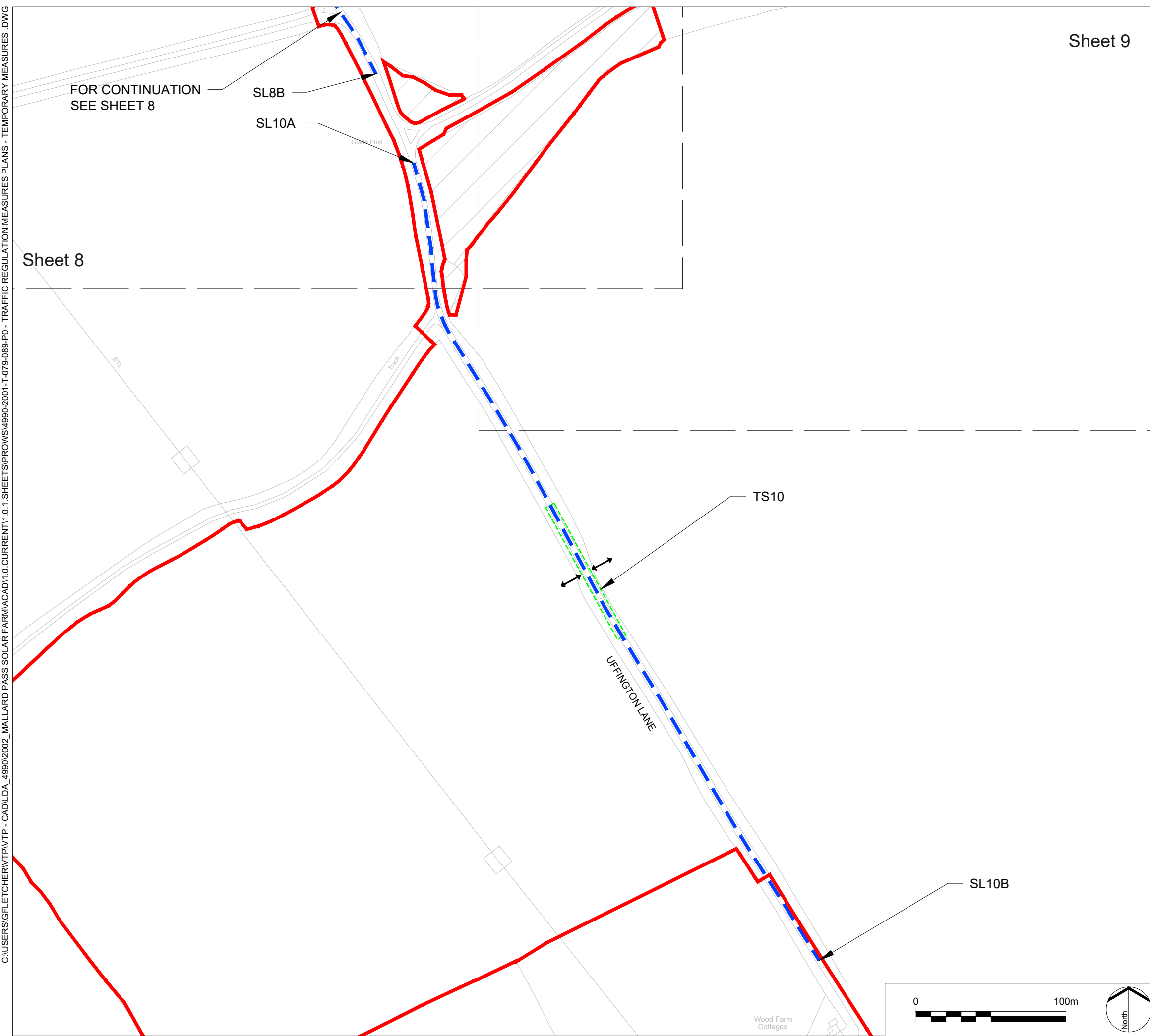

- LEGEND**
- Order limits
  - Areas outside of Order limits
  - Proposed Temporary Speed Limit (30mph Speed Limit)
  - Proposed Temporary Traffic Signal Control Area
  - Proposed Site Access Location

- NOTES:**
1. The Traffic Regulation Measures Plans should be read in conjunction with the Development Consent Order and the other plans and documents to be certified under it, in particular article 15, and Schedule 8 of the Development Consent Order.
  2. Information relating to the Public Rights of Way and accesses can be found on the rights of way and access plans.
  3. The Order limits has been drawn to the Land Registry boundaries and topographical survey data of the site. The accuracy of land registry and the topographical survey differs from the OS base mapping which results in the order limits not aligning with the line work shown on the OS mapping.

P0	Submission	RP	18/11/22
REV.	DESCRIPTION	APP.	DATE



**PROJECT TITLE**  
**MALLARD PASS SOLAR FARM**

**DRAWING TITLE**  
**TRAFFIC REGULATION MEASURES PLANS**  
**- TEMPORARY MEASURES - SHEET 10 OF 10**  
**Infrastructure Planning (Applications:**  
**Prescribed Forms and Procedure) Regulations**  
**2009**  
**APFP Regulation: 5(2)(o)**

**PINS REFERENCE NO**  
**EN010127**

ISSUED BY	Oxford	T: 01865 887 050
DATE	18 NOV 2022	DRAWN GSF
SCALE@A3	1:2,500	CHECKED CR
STATUS	Planning	APPROVED RP

**DWG. NO 4990-2001-T-089**      **REV : P0**

No dimensions are to be scaled from this drawing.  
 All dimensions are to be checked on site.  
 Area measurements for indicative purposes only.

© LDA Design Consulting Ltd. Quality Assured to BS EN ISO 9001 : 2015  
 Sources Ordnance Survey

C:\USERS\FLETCHER\PIVTP - CAD\DA\_49902002\_MALLARD PASS SOLAR FARM\CAD\1.0.CURRENT\1.0.1.SHEETS\PROWS\4990-2001-T-079-089-P0 - TRAFFIC REGULATION MEASURES PLANS - TEMPORARY MEASURES.DWG

